

भारतीय प्रौद्योगिकी संस्थान रोपड़
INDIAN INSTITUTE OF TECHNOLOGY ROPAR
NALANDA LIBRARY



BROCHURE

NALANDA LIBRARY



THE INSTITUTE

The Indian Institute of Technology Ropar (IIT Ropar) is an engineering and technology Institute that was established in the year 2008, located in Rupnagar (Ropar), Punjab, India. It is a part of the prestigious Indian Institutes of Technology system which has been the cornerstone of higher technical education in India. Indian Institute of Technology Ropar is ranked 22nd best engineering institute according to NIRF 2024, ranked as 48th in overall ranking and it is ranked 45th in research institutions category. It is one of the new IITs set up by the erstwhile Ministry of Human Resource Development (MHRD), now Ministry of Education, Government of India, to expand the reach and enhance the quality of technical education in the country. The institute is committed to providing the state-of-the-art technical education in a variety of field and also for facilitating transmission of knowledge in keeping with latest developments in pedagogy. The academic structure at IIT Ropar is designed to foster a robust educational environment. It offers Undergraduate, Postgraduate, and Doctoral programs across various disciplines of engineering, science, and humanities. Indian Institute of Technology Ropar is not just a premier engineering institution but a vibrant academic ecosystem that nurtures future leaders in technology and science. With its focus on high-quality education, research, and innovation, IIT Ropar plays a crucial role in advancing the frontiers of knowledge and contributing to the development of the nation and the world.

NALANDA LIBRARY

Library at IIT Ropar is your window to the world of latest information in Science, Engineering Technology, and Humanities & Social sciences. Being an integral part of an academic and research work on the campus, Library provides information services to support the teaching learning, research and outreach activities of the institute by creating state-of-the-art facilities and offering innovative services.



Library functions as the primary information resource centre and repository of printed and electronic resources. Apart from textbooks and recommended reading materials prescribed for each course offered at the institute, the library houses a growing collection of research monographs, reports, multi-volume reference work, dictionaries, encyclopedias, handbooks, and so on. In addition, the library also facilitated access to a large number of journals through its participation in consortia, such as E-Shodh Sindhu. The library has fast growing collection of books, journals, magazines both in print and digital format. At present, users can consult more than 25,000 books (Available on the shelves) and thousands of electronic journals. Online access is also provided to bibliometric and scientometric databases/Softwares/Tools such as Web of Science, Scopus MathSciNet, SciFinder Scholar, Prowess IQ, Trunitin, Grammarly, Overleaf.

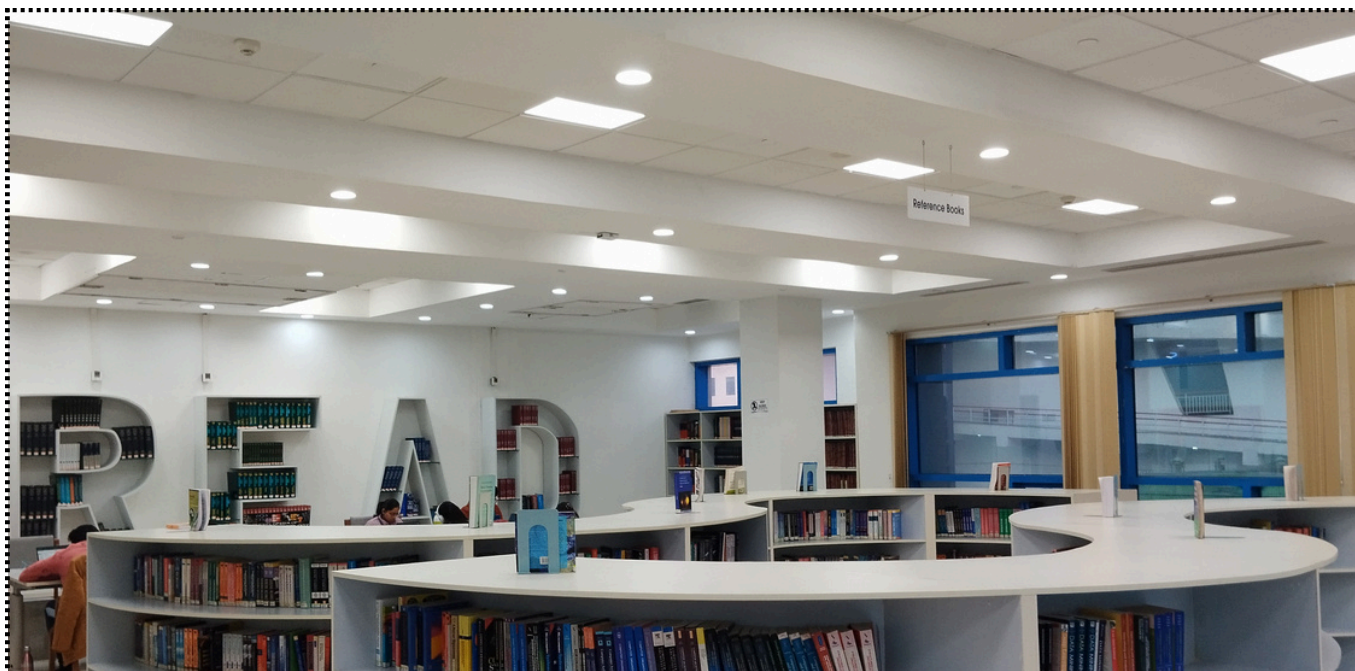

The Library operations have been fully automated using KOHA (Library Management Software), most of the services of the library are fully computerized. An RFID system has been implemented facilitating self- check-out, check-in of library materials for enhanced security. A separate e-resource section is provided in the library to browse CDs and DVDs of books; theses and dissertations. It has an institutional repository (IDR) to archive and provide access to intellectual output of the institute. It also has its website which serves as one-point access to all resources and services. The library accommodates 240+ readers at a time and it is open 24/7 on all days of the year. This helps greatly in enhancing the library's efficiency in making the resources available to the academic community at large and also enables the institute participate in various inter-library initiatives at national and international levels.

LOCATION & SPREAD

Nalanda Library is situated in the back side of the Vivekananda Auditorium. The library is housed in two floor. The arrangement of various sections of library is given below:

GROUND FLOOR

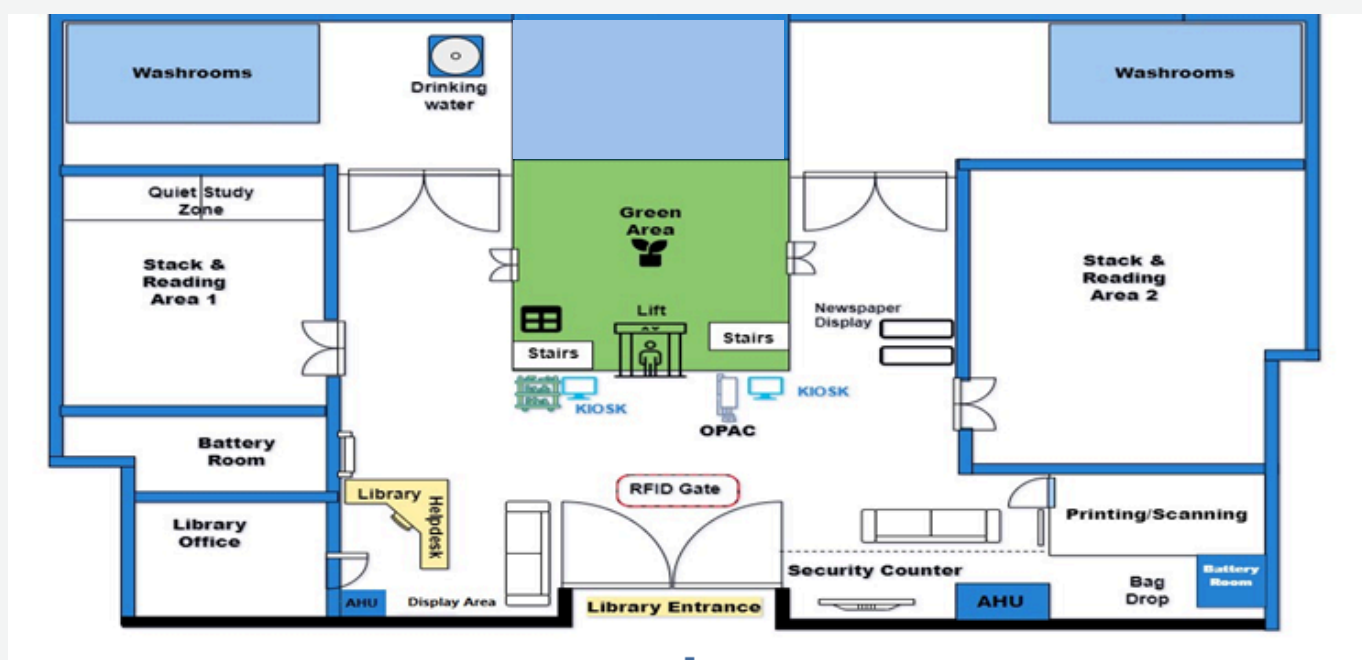

FIRST FLOOR

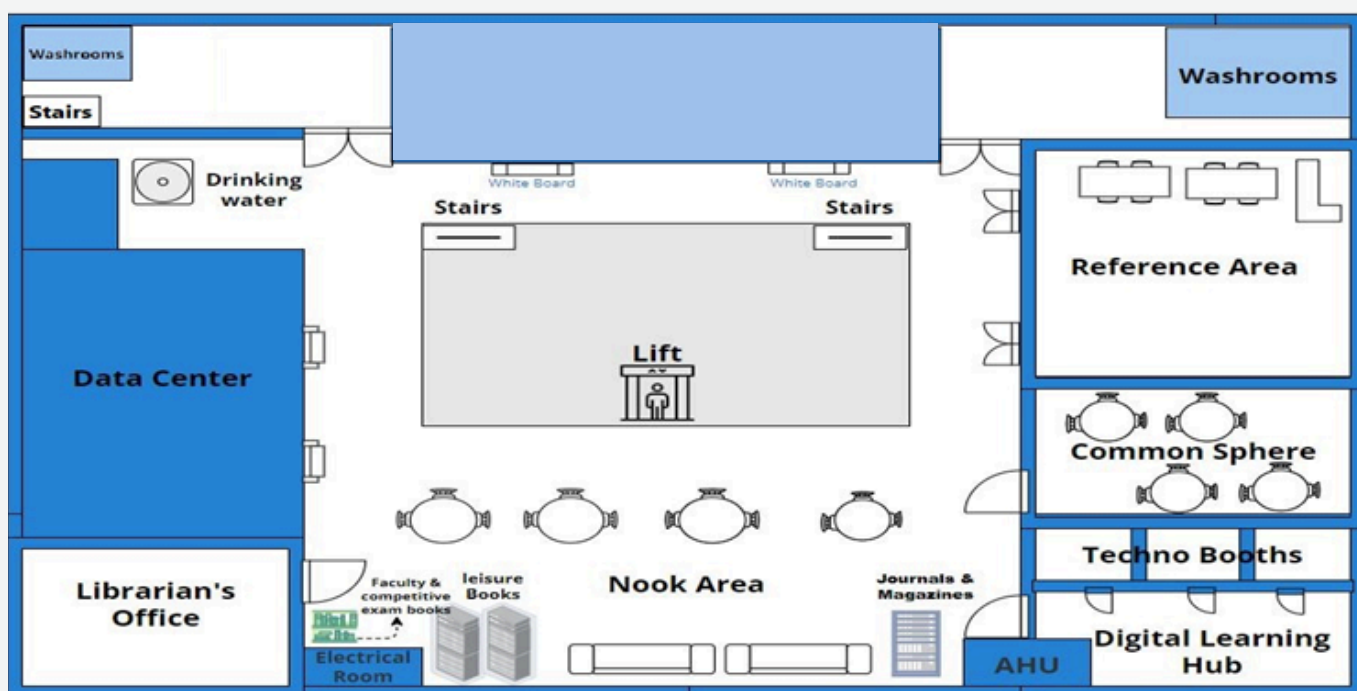

LIBRARY MEMBERSHIP, CIRCULATION POLICIES AND GUIDELINES

All registered students, faculty and staff of the institute are entitled for library membership. The faculty members, staff and students of the institute are required to enroll as member of the Library (upon joining the institute) by filling the online application form through this QR code available here.



USER PRIVILEGES

Member Category	No. of Books to be Issued	Duration
Faculty	12 Books	General & Reference Books: 06 months
Staff	04 General Books	06 months
Ph.D. Scholars	06 Books (05 General and 01 Reference)	General Book: 28 days Reference Book: 07 days
PG Students	05 General Books	14 days
UG Students	03 General Books 01 Book Bank Book	General Books: 14 days Book Bank Book: 06 months

LIBRARY TIMINGS: Library opens all the days of the year.

Ground Floor: 24/7 (Stack and Reading area 2)

First Floor: 6 am to 2 am.

COLLECTION

The library has collection of over 25000 + books covering the disciplines of Computer Science, Chemical Engineering, Artificial Intelligence and Data Engineering, BioMedical Engineering, Electrical Engineering, Civil Engineering, Mechanical Engineering, Metallurgical and Materials Engineering, Science & Technology, Management, Humanities and Social Sciences. The library also houses a growing collection of books in Hindi, English fiction, General and Competitive Books.

Electronic Resources:

E-Journals

- Acta Arithmetica
- American Chemical Society (ACS) Journals
- American Institute of Physics (AIP) Journals
- Annals of Mathematics (Princeton University)
- Annual Review (AR)
- American Physical Society (APS) Journals
- American Society of Civil Engineers (ASCE) Library
- American Society of Mechanical Engineers (ASME) Journals
- Association for Computing Machinery (ACM) Digital Library
- Cambridge University Press (CUP) selected Journals
- Elsevier's ScienceDirect Journals
- Economic & Political Weekly
- Emerald CFTI Collection
- IEL Online (IEEE Journals)
- Institute of Physics Science (IoP) Journals
- JSTOR
- Optical Society of America (OSA) Journals Oxford University Press (OUP) Journals
- Proceedings of the National Academy of Sciences (PNAS)
- Project Muse
- Royal Society of Chemistry (RSC) Journals
- Royal Society Proceedings A: Mathematical, Physical and Engineering Sciences
- Science Online
- Springer Journals
- Springer Nature Journals
- Nature Main Title
- Taylor & Francis Journals
- Thieme Chemistry Package
- Wiley selected Journals

Books

- Research Monographs
- Textbooks
- Reference Books
- Hindi Books
- Fiction Books
- **CDs/DVDs**
- **Journals in Print**
- **Technical Reports**
- **Theses & Dissertation**

Databases/Software/Tools:

- Grammarly Tool
- Institute for Studies in Industrial Development (ISID)
- MathSciNet
- Overleaf
- Prowess IQ
- SciFinder Scholar
- Scopus
- States of India
- Turnitin (Anti-Plagiarism) Tool
- Web of Science

E- books

- Begell House Engineering Collection (List of Titles)
- Pearson e-Library Collection (List of Titles)
- South Asia Archive (SAA)
- Springer Lecture Notes in Physics (List of Titles)
- The Market for Nanobubbles
- World e-Book Library

ARRANGEMENTS OF COLLECTION:

All books in print are classified as per the Dewey Decimal Classification (DDC) system and arranged by classification numbers (Subject wise) on the shelves. The detailed shelf and row guides are provided in the stack area for easy location.

Area	Books (Class No.)
Stack & Reading Area 1 (Ground Floor)	Computer Science; Basic Sciences; Humanities (Class No. -000-599)
Stack & Reading Area 2 (Ground Floor)	Engineering and Technology; The Art (Class No.600-799) Book Bank Stack
Reference Section (First Floor)	Artificial Intelligence and Data Engineering, BioMedical Engineering, Chemical Engineering, Civil Engineering, Computer Science & Engineering, Electrical Engineering, Mechanical Engineering, Metallurgical and Materials Engineering, Chemistry, Physics, Mathematics, Humanities and Social Sciences

RFID SYSTEM

RFID technologies facilitate easy lending process and provide security for the library through EAS gates using bit featured RFID tags. The lending of library material is through self-service kiosk, which results in quicker operations with shorter queue.



BORROWING RULES

- Books can be borrowed only through your RFID Smart ID card from KIOSK.
- Smart ID card is non-transferable. A payment of Rs. 300/- is applicable on loss of the card, charges are double on each re-issue of the duplicate card.
- The borrower is responsible for the misuse or loss of the Smart ID card.
- Before issuing the book, the user should check it properly to ensure that there is no damage, if so missing pages, report to library circulation counter, otherwise he/she will be held responsible for damage, if found at the time of returning of the book.
- Books will not be accepted in damaged or mutilated condition from the users at the time of returning.
- In case of lost books, the borrower is required to replace the book with a recent edition.
- The lost or mutilated book should be brought to the notice of library staff immediately.
- If the book is not available anywhere for purchase, the borrower must pay twice the cost of the volume.
- Theses/Dissertation, DVD/CDs and periodicals cannot be borrowed by library users. Back volumes of periodicals can be borrowed for 2 days.
- A document issued may be renewed provided there is no reservation against it.
- Borrower should bring the books physically to the library for renewal.
- The library has the right to call back any issued book/item at any time.
- All books need to be returned for physical verification when intimated irrespective of the date of issue and category of users.
- Browsing of websites which violates the dignity of the institution research work, distract other users attention is prohibited inside the library.



Conventions for Issue/ Return

- Books from general collections are issued to all eligible members as per their entitlement.
- Book Bank Books are issued to undergraduate students for a period of six months.
- Reference Books marked in green label are issued on demand only to faculty and research scholars for a period of one week only.
- Reference materials such as encyclopedia, dictionaries, handbook etc. is not issued out of the library.



OVERDUES

Borrowers are responsible for returning books issued to them on or before the due date. All overdue items are fined at **Rs. 2.00 per item, per day**. The fine **will be doubled in the second week, and tripled in the third week and so on**. However, the fine should not exceed a maximum of 10,000.

LIBRARY SERVICES AND FACILITIES

Reference Service:

This service helps you to make use of the resources available in the library. The library staff members provide you guidance on the use of information resources such as Journals, e-Books, Online Public Access Catalogue (OPAC).

New Arrivals:

Newly procured books are displayed in the new arrival areas, to inform users about the additions. Users can also check for new arrivals through OPAC.

Book Bank:

Book Bank Service is made available to the UG Students. Students can borrow one book from the book bank category and can retain for entire semester.

Photocopy and Printing:

Library Xerox/photocopy service is available on nominal charges [Re. 1/- per page (one side) for photocopy and print charges] and users must adhere to copyright laws. Any copyright infringement is the responsibility of the users.

Electronic Document Delivery Service:

It refers to the delivery of the article(s)/chapter(s)/electronic copies of the document which are not a part of our collection from the member libraries. You can send your request to: subscriptions@iitrpr.ac.in

Plagiarism/Similarity Check Report:

Library also provides the similarity check report to the student of the institute for the submission of their dissertation and theses.

Event Services:

Library conducts various events on the auspicious days, for updation of knowledge; to build one to one collaboration with the users.

Subjects/Research Guides portal:

This is designed to help the library users to easily find the quality resources and information relevant to their subject areas/department through a single window research. Resources covered include print and electronic documents. Users can choose the subject from the list to get started. It is useful in support of academic, research and professional work.

Research Support Services (RSS) for the Scholarly Community

The library offers comprehensive Research Support Services designed to empower students in their academic and research journey

1.1 Empowering Research with Digital Resources: Our vast collection of e-journals (Around 9500 e-journals) spans diverse academic disciplines, providing access to journals/articles from publishers across the world.

1.2 Research Writing Assistance: The library provides access to Grammarly and Overleaf Tools, helping researchers improve their writing skills and simplifying the process of writing academic documents, especially those with complex formatting requirements.

1.3 Copyright and Plagiarism Prevention with Turnitin: The library provides access to Turnitin, an anti-plagiarism and detection tool that helps researchers ensure the originality of their work by comparing it against a vast database of academic and online sources.

1.5 Workshops from the Publishing Industry and Editorial Boards: The library invites experts from the publishing industry to conduct workshops on topics such as manuscript preparation, peer review processes, publishing in high-impact journals, publishing ethics, etc.

1.6 Providing Research Data: Through the subscription to the States of India Database and Prowess IQ, the library provides comprehensive access to statistical and financial data on Indian and global levels.



1.7 e-Interlibrary Loan (e-ILL) for Research Articles: The library has collaborated with a vast network of libraries to provide a wide range of materials. Our e-ILL service allows researchers to request articles and other materials from libraries in India and around the world.

1.8 Support on Faculty Research Publications: The library provides extensive support for faculty research publications, compiling and broadcasting publications digest on monthly basis, providing details about key metrics such as journal impact factors, article citation counts, and Scopus quartile rankings etc.

1.9 Providing Subjects/Research Guides: The Subjects/Research Guides portal is designed to help users easily find quality resources and information relevant to their subject areas/department.

OPAC (<https://opac.iitrpr.ac.in>)

Online Public Access Catalogue (OPAC) enables library users to know their checkout status, issue history and so on. Users can browse for new additions of books, journals subscribed (author, title, publisher wise). They can also check status of books, and avail more advanced services.

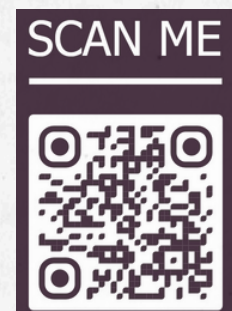



Nalanda Library

Indian Institute of Technology Ropar

Punjab - 140001

Online Public Access Catalogue

Title

Thermodynamics

[Advanced search](#) | [Authority search](#) | [Tag cloud](#) | [Library](#)

Home > Results of search for 'Thermodynamics'

Refine your search

Availability

Limit to currently available items

Authors

Gaskell, David R.

Gurtin, Morton E.

Honig, J. M.

Hougen, O.A. ... [et ...]

McQuarrie, Donald A...

[Show more](#)

Collections

Reference

Item types

Book Bank

Books

Reference Books

Locations

Book Bank Books

Your search returned 144 results.

1 2 3 4 5 6 7 8 Next » Last »

Relevance

Unhighlight | Select all | Clear all | Select titles to: Add to... Save Place hold

☐ 1. **Thermodynamics, statistical thermodynamics and kinetics**

by Engel, Thomas and Reid, Philip

Material type: Text

Language: English

Publication details: Pearson 2006

Availability: **Items available for loan:** Nalanda Library (1).

[Place hold](#) [Add to cart](#)

☐ 2. **Thermodynamics, statistical thermodynamics, and kinetics**

by Engel, Thomas and Reid, Philip

Edition: 3rd ed.

Material type: Text

Language: English



Image from Amazon.com

Normal view

MARC view

ISBD view

Thermodynamics tables of accompany modern engineering thermodynamics

By: Balmer, Robert T Q

Material type: Text

Language: English

Publication details: Elsevier 2011

ISBN: 9780123749963

DDC classification: 621.4021 T11 BAL

Tags from this library: No tags from this library for this title. [Log in to add tags.](#)

Holdings (1)

Comments (0)

Item type	Current library	Call number	Status	Date due	Barcode	Item holds
Books	Nalanda Library <i>Circulation Books</i>	621.4021 T11 BAL (Browse shelf)	Available		6965	

11

INSTITUTIONAL REPOSITORY

The library has developed an Institutional Digital Repository using DSpace. IDR holds online resources, such as PhD theses, research publications of the Institute. The repository ensures wide visibility and long-term preservation of the institute's research output, making it accessible to future researchers and scholars. For more details, please visit institutional repository webpage at <http://dspace.iitrpr.ac.in:8080/xmlui/>



INSTITUTIONAL DIGITAL REPOSITORY

DSpace Home

DSpace Repository

DSpace is a digital service that collects, preserves, and distributes digital material. Repositories are important tools for preserving an organization's legacy; they facilitate digital preservation and scholarly communication.

Communities in DSpace

Select a community to browse its collections.

- [MS Research Theses](#) [6]
- [Ph.D Theses](#) [251]
- [Research Publications](#) [4017]

Recently Added

[Integrated experimental and theoretical studies on structural and magnetic properties of thin films of double perovskite ruthenates: Ba₂DyRuO₆ & Sr₂DyRuO₆](#)
Dani, S; Kumar, R; Sharma, H; Choudhary, R J; Goyal, N; Kaur, P; Pandit, R (2024-07-30)
Abstract: Thin films of double perovskite ruthenates, viz., Ba₂DyRuO₆ (BDRO) and Sr₂DyRuO₆ (SDRO), have been successfully grown on a SrTiO₃ substrate using the pulsed laser deposition technique. The BDRO samples crystallizes ...

[Elucidation of Structural, Morphological, Electrical Parameters, and Anti-Bacterial Activity of Polyaniline-Nanocomposite: New Paradigm of Controlling Bacterial Activity](#)
Singh, C; Sharma, S; Jaglan, S; Apesteguy, J C.; Jacobo, S; Kaur, R (2024-07-30)
Abstract: In this communication, we purpose an alternative electrical method to determine the anti-bacterial activity of

Search DSpace

[Advanced Search](#)

Browse

All of DSpace
[Communities & Collections](#)
[By Issue Date](#)
[Authors](#)
[Titles](#)
[Subjects](#)

My Account

[Login](#)
[Register](#)

Discover

Author

- [Singh, N. \(281\)](#)
- [Singh, H. \(196\)](#)
- [Kumar, S. \(164\)](#)
- [Kaur, N. \(148\)](#)
- [Srivastava, R. \(145\)](#)
- [Kumar, R. \(129\)](#)
- [Kumar, M. \(124\)](#)
- [Kumar, N. \(120\)](#)

IMPORTANT GENERAL RULES

(https://www.iitrpr.ac.in/library/library_rules.php)

- Please bring Institute Smart ID Card while using the Library as it is necessary for Library transactions.
- Please maintain the decorum, peace and silence within the premises of library.
- Please handle Library materials with utmost care.
- Use of personal stereos, music-sets, mobiles etc. in the library is not permitted.
- Audible use of mobile phones is not permitted in the library.
- Keep your personal belongings at the property counter.
- Eatable are not allowed in the library.
- No material from the library should be taken out without proper issuing/ recording.

CODE OF CONDUCT

- Maintain a quiet study atmosphere. Silence must be observed in the library at all times.
- Food and drinks are not allowed inside the library.
- No bags or cases are permitted in the library.
- All library materials and personal belongings must be shown to the guard at the entrance at the time of entry and exit from the library.
- All library users, when making copies of library materials, should strictly adhere to copyright laws.
- Personal belongings should not be left unattended.
- Library is not responsible for any loss or damage of personal belongings.
- Use of mobile phones inside the library is strictly prohibited.
- All books need to be returned for physical verification once a year, irrespective of the date of issue and category of users.
- No material from the library should be taken out without proper issue. Taking books without adhering to the procedure will invite disciplinary action.
- Faculty and staff going on long leave, deputation, study leave or extraordinary leave will have to return all the borrowed materials before leaving the institution.
- Browsing the website which violates the dignity of the institution is prohibited inside the library.

FOLLOW US ON SOCIAL MEDIA

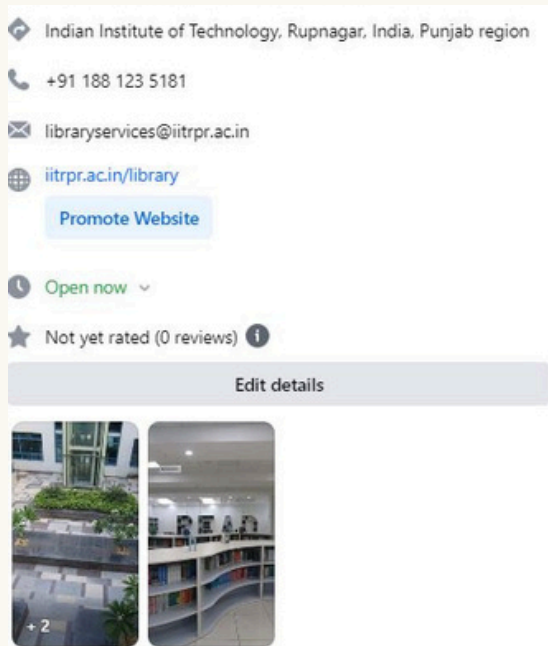

The Central Library, Nalanda Library of IIT Ropar functions as a primary information resources centre and repository of printed and E-Resources. The library has a fast growing collection of books, journals, magazines both in print and digital format covering most disciplines taught and researched at the Institute. Library Collection includes Books, Textbooks, Reference Books, Thesis, Dissertation, Monographs and so on. At Present there are more than 25, 000 books available a... See more



Facebook



Instagram

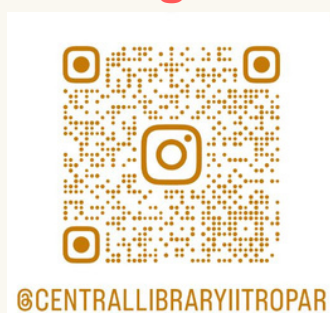

LinkedIn



CONTACT INFORMATION

Dr. Dinesh K.S

Librarian

Head Nalanda Library

✉ librarian@iitrpr.ac.in

☎ 01881-235179

Dr. Tarvinder Singh Handa

Assistant Librarian

Subscription & Document Delivery Service

✉ subscriptions@iitrpr.ac.in
tarvinder.singh@iitrpr.ac.in

☎ 01881-235184

Dr. Harpreet Kaur

Library Information Officer

Acquisition and Technical Processing

✉ library@iitrpr.ac.in
harpreetkaur@iitrpr.ac.in

☎ 01881-235182

Mrs. Amrita Bhattacharya

Library Information Officer

Circulation and User Services

✉ libraryhelpdesk@iitrpr.ac.in
amrita.bhattacharya@iitrpr.ac.in

☎ 01881-235183

Mr. Vineet Jamwal

Library Information Assistant

Circulation

✉ vineet.jamwal@iitrpr.ac.in

☎ 01881-235181



NALANDA LIBRARY INDIAN INSTITUTE OF TECHNOLOGY ROPAR RUPNAGAR PUNJAB-140001

"We value your presence"